

- 1 BRASS BLADE
- 2 BRASS GROUND PIN
- 3 BRASS GROUND TERMINAL
- 4 BRASS TERMINAL
- 5 MOULDED THERMOPLASTIC
- 6 RETAINING CLIP

WHERE "cc" REPRESENTS COLOUR CODE I.E. "BK" IS BLACK
 WHERE "w" REPRESENTS NUMBER OF WIRES FROM 3 TO 5

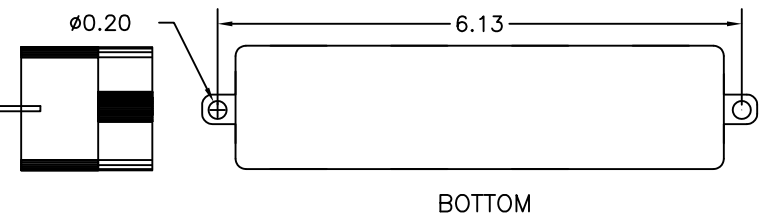

SYSTEM IS RATED FOR CONNECTION TO A GROUNDED 125/250V BRANCH CIRCUIT.
INSTALLATION IN ACCORDANCE WITH THE CEC PART I OR THE NEC.
ACCEPTABLE FOR USE IN ENVIRONMENTAL AIR SPACES OTHER THAN DUCTS OR PLENUMS
PER CEC PART I 12-010(3) OR NEC 300-22(C).
MEETS OR EXCEEDS: - CSA 22.2 NO. 203.1
- UL 183



125/250 Volt 20 Amp

CDN. PATENT - 1219307

U.S. PATENT - 4775802

ITEM	DESCRIPTION		

100-5977 HAZELDEAN ROAD, OTTAWA, ONTARIO, CANADA K2S 1B9
 TELEPHONE (613) 836-0300 FAX (613) 836-0391
 TOLL-FREE (866) 233-5328 FAX (866) 933-1933
 e-mail: support@electeonline.com

MULTI TAP

w6TAP_{cc}

DRAWN BY: J.Y.	APPROVED: D.H.	w6TAP.8
DATE: 10-DEC-08	SCALE: N.T.S.	

OWNERSHIP OF DOCUMENTS
 This drawing and accompanying information as instrument of service are the property of **ELECTEC**.
 Reproduction or use in whole or in part in any form whether the work for which they are presented be executed or not is forbidden without the express written permission of **ELECTEC**.