

- ① BRASS BLADE
- ② BRASS GROUND PIN
- ③ BRASS GROUND TERMINAL
- ④ BRASS TERMINAL
- ⑤ MOULDED THERMOPLASTIC
- ⑥ RETAINING CLIP

WHERE "cc" REPRESENTS COLOUR CODE I.E. "BK" IS BLACK

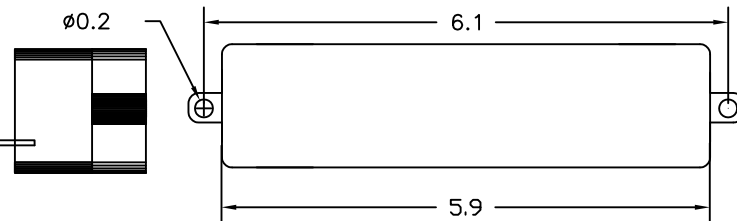

**SYSTEM IS RATED FOR CONNECTION TO A GROUNDED 277V OR 347V BRANCH CIRCUIT.  
 INSTALLATION IN ACCORDANCE WITH THE CEC PART I OR THE NEC.  
 ACCEPTABLE FOR USE IN ENVIRONMENTAL AIR SPACES OTHER THAN DUCTS OR PLENUMS  
 PER CEC PART I 12-010(3) OR NEC 300-22(C).  
 MEETS OR EXCEEDS: - CSA 22.2 NO. 203.1  
 - UL 183**



LR 91749

277 OR 347 Volt 20 Amp

CDN. PATENT - 1219307

U.S. PATENT - 4775802

ITEM	DESCRIPTION		



100-5977 HAZELDEAN ROAD, OTTAWA, ONTARIO, CANADA K2S 1B9  
 TELEPHONE (613) 836-0300 FAX (613) 836-0391  
 TOLL-FREE (866) 233-5328 FAX (866) 933-1933  
 e-mail: support@electeonline.com

**OWNERSHIP OF DOCUMENTS**  
 This drawing and accompanying information as instrument of service are the property of **ELECTEC**.  
 Reproduction or use in whole or in part in any form whether the work for which they are presented be executed or not is forbidden without the express written permission of **ELECTEC**.

SWITCH TAP  
 103347SWlcc

DRAWN BY: J.Y.	APPROVED: D.H.	103347SWI.7
DATE: 10-DEC-08	SCALE: N.T.S.	